

## SmartLink™ SL-4-AC RDM Controller

### Remote Device Management for AC Devices

- Reboot Devices Remotely
- Change Run-Times Remotely
- Cloud-Based Proof of Performance
- Power Outage Alert Notifications
- Centralized Inventory Management for Field Assets
- Manage up to 4 Devices from One Controller

SmartLink is an asset management system designed to remotely manage and control field assets from one centralized platform. The SL-4-AC controller remotely monitors, schedules, and reboots up to four AC assets through its cloud-based management system. When assets go offline, the SL-4-AC notifies users and enables remote rebooting through its 4G LTE connection. The SL-4-AC provides clarity on whether issues are caused by lack of power or lack of connectivity, which speeds up troubleshooting and reduces asset downtime.

The SL-4-AC allows up to four assets to operate on separately scheduled run-times with individual week-day scheduling capabilities. The SmartLink system offers a Smart Weather feature to activate devices during unplanned inclement weather and has an open API to integrate into Content / Inventory Management Systems and CAD-AVL platforms.

OutdoorLink has installed over 85,000 SmartLink systems globally and provides 24/7 technical support from its Huntsville-based support team.

#### Commonly Managed Devices:

- |   |   |  |
|---|---|--|
| <input type="checkbox"/> LED and LCD Signage              | <input type="checkbox"/> Illuminated Static Advertising | <input type="checkbox"/> Audio Annunciators / Speakers |
| <input type="checkbox"/> Bus Stop Shelter & Pole Lighting | <input type="checkbox"/> WIFI Routers                   | <input type="checkbox"/> Text-to-Speech Push Buttons   |
| <input type="checkbox"/> TVMs and Card Readers            | <input type="checkbox"/> Media Players                  | <input type="checkbox"/> Security Cameras & Webcams    |

#### Technical Specifications:

Device Management	Manages up to 4 AC devices
Runtime Settings	Automatic, GPS based sunrise/sunset times and/or manual time scheduling with integrated real-time clock
Enclosure	Polycarbonate, 10.5 in. x 10.7 in. x 3.4 in. with integrated latch and vandalism detection sensor
Bare Board Option	7 in. x 7 in. x 2 in.
Input Power	30A max per relay
Output Power	17A per relay
Power Consumption	0.13A max @ 120V
Connectivity	Off-band cellular 4G LTE with internal SIM and integrated antenna
Operating/Storage Temp.	-40°C to 75°C
Environmental	NEMA 3/IP54, water and dust proof, 0-95% humidity, non-condensing, RoHS
Wiring Connection	3 ft. wiring harness with 10 AWG supply and 12 AWG load wires
Testing	Manual push button per relay
System Reporting	Power Readings, Proof of Performance, Command Log, Alarm History, Maintenance Log
Alarm Notifications	Loss of Power, Power Restore, Tampering
Certifications	UL/cUL Listed, FCC Class B Certified, PTCRB Certified, AT&T and Verizon Certified, Buy America Compliant

## SL-4-AC Hardware Specs

SmartLink controllers are UL Listed and IP rated for damp, outdoor conditions. The SL-4-AC polycarbonate enclosure is engineered to be installed onto existing infrastructure in the elements, or integrated into third-party housing like utility boxes, shelters or totems.

The SL-4-AC enclosure is equipped with a tamper detection system and sends an alarm to the SmartLink system anytime the enclosure has been opened.



SL-4-AC Outside View



SL-4-AC Inside View

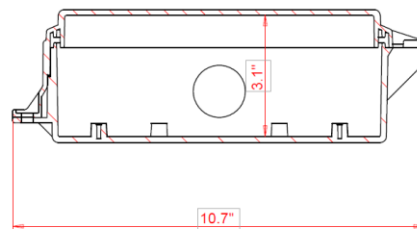
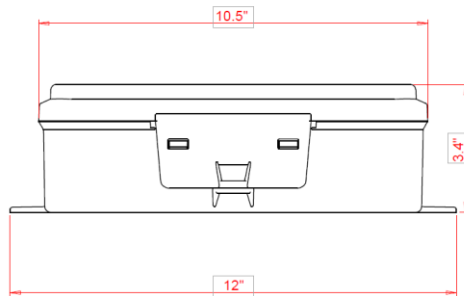

### SL-4-AC Outside Dimensions

Height	3.4 in.
Width	10.5 in.
Length	10.7 in.